

EastLake Village Center South

SWC Otay Lakes Road & EastLake Parkway
Chula Vista, CA 91915



FOR LEASE

±1,823 SF • LAST SPACE AVAILABLE
Leasing Incentives! (Call Broker for Details)

**FLOCKE &
AVOYER**

Commercial Real Estate

EastLake Village Center South

2210-2290 Otay Lakes Road
Chula Vista, CA 91915

±1,823 SF SMALL
SHOP SPACE
AVAILABLE IN
DOMINANT GROCERY
ANCHORED CENTER



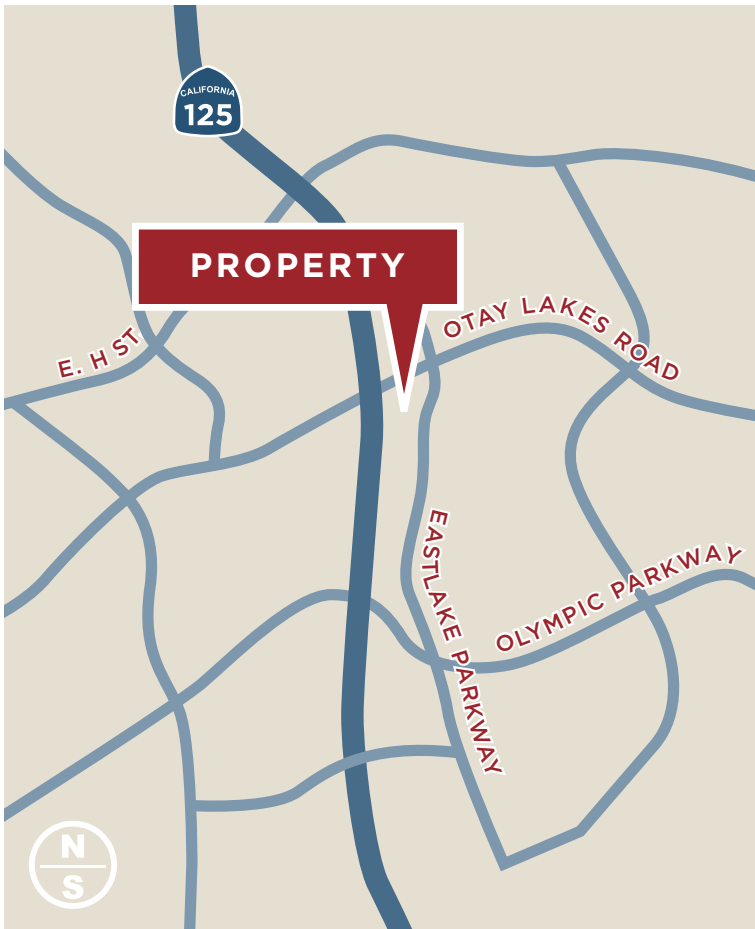

SHOP

| DINE

| RELAX

PROPERTY DESCRIPTION

Anchored by Vons and Rite Aid, EastLake Village Center South is located in the middle of the dynamic EastLake community.

This is a rare opportunity for a small shop space in the most dominant grocery-anchored center located at the main intersection in the EastLake community.



TRAFFIC COUNTS

CARS PER DAY

OTAY LAKES ROAD: $\pm 40,800$
EASTLAKE PARKWAY: $\pm 23,900$



AVERAGE HHI*

1 MILE: \$106,444
3 MILES: \$109,747
5 MILES: \$103,036



POPULATION

1 MILE: 18,726 / 9,815 (DAY)
3 MILES: 103,468 / 45,049 (DAY)
5 MILES: 192,837 / 90,279 (DAY)



**Demographics produced using private and government sources deemed to be reliable.
The information herein is provided without representation or warranty. Additional information available upon request.*

SITE PLAN

SUITE	TENANT	SF
101	Project Pie	1,732
102	Poke Bay	1,200
103	Pansang's Filipino Cuisine	1,248
104	Panda Chef	1,248
105	L&L Hawaiian BBQ	1,792
106	Verizon	1,953
107	VIP Nails & Spa	968
108	Flame Broiler	1,224
109	Baskin Robbins	982
110	Samuel Hayatt, DMD	1,224
111	Optometry EastLake Vision	968
112	Arya Cleaner	2,039
113-115	Veterinarian - Dr. Bischel	4,286
301	Studio MG Salon	1,205
302	AVAILABLE	1,823
303	Weight Watchers	1,835
304-305	Citibank	2,450
306-307	Realty Executives	2,537
501	Goodwill Bookstore	1,925
502	Postal Annex	1,188
503	HearUSA	1,120
504	H&R Block	1,330
505-506	Papagayos Grill	2,694

This site plan is not a representation, warranty or guarantee as to size, location, or identity of any tenant, and the improvements are subject to such changes, additions, and deletions as the architect, landlord, or any governmental agency may direct.

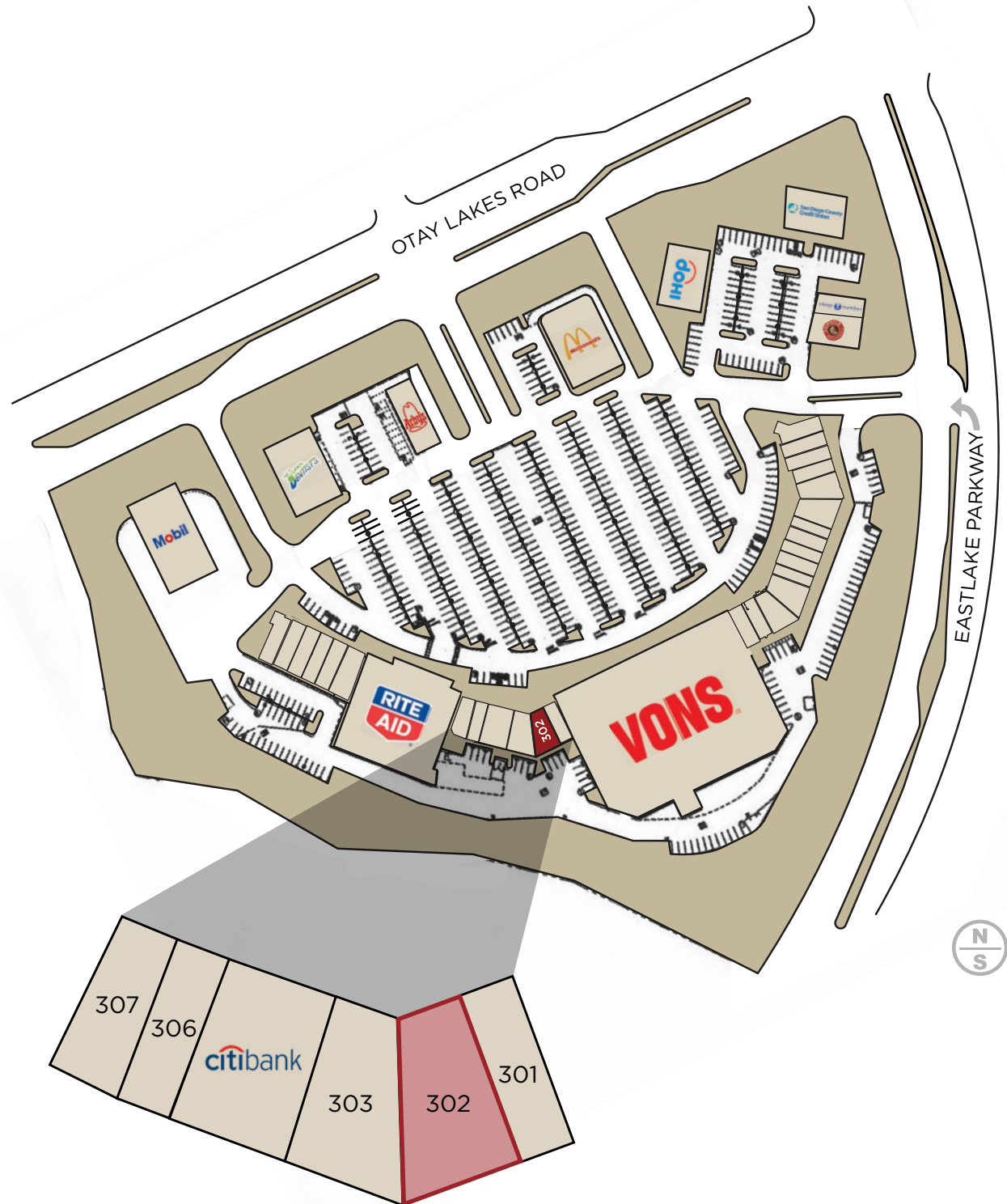

AERIAL

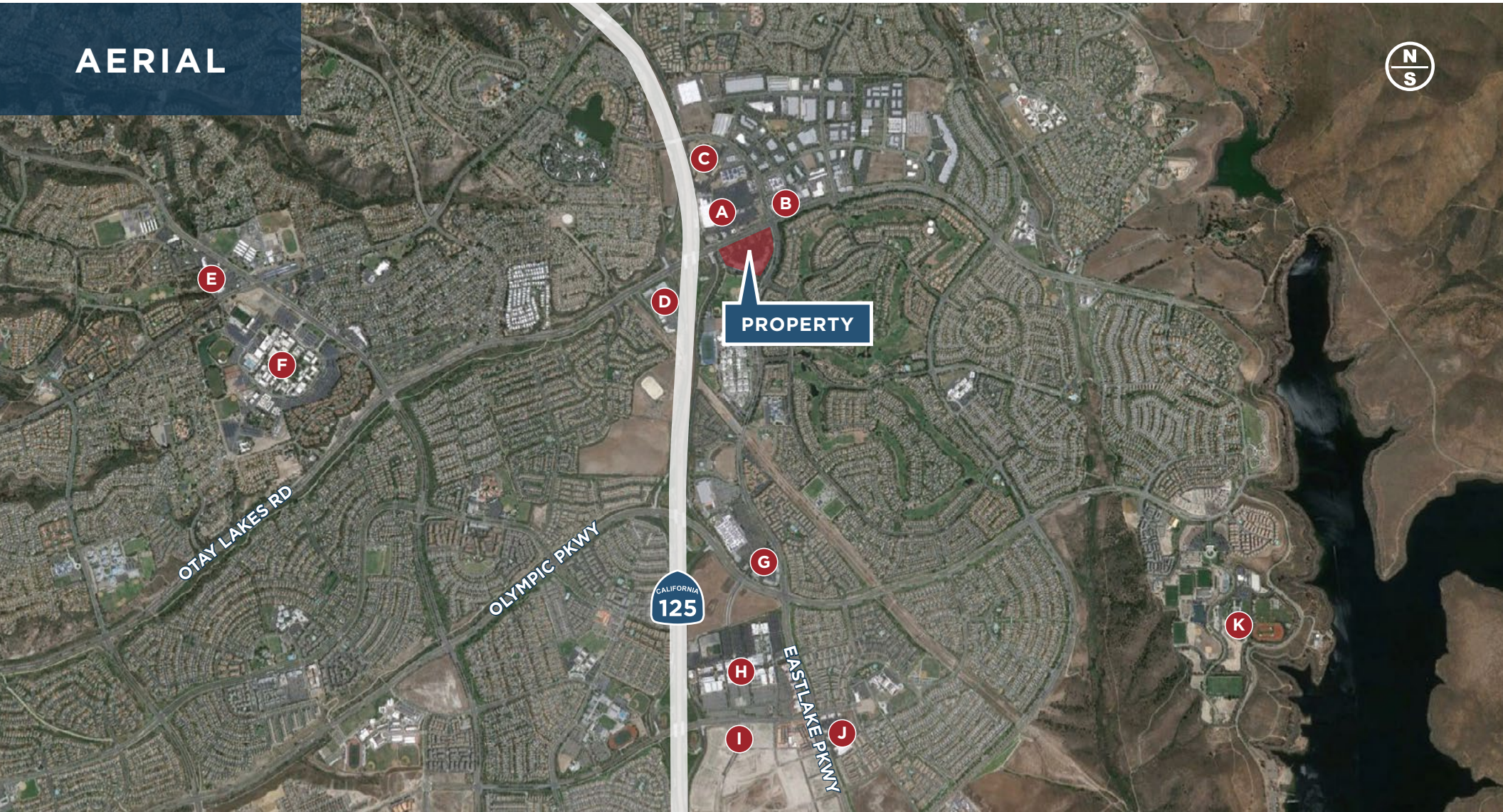

- A** Target, Lowe's, Bevmo, Office Depot
- B** Kohl's
- C** Sprouts, Trader Joes, TJ Maxx, CVS, Petco, Pier 1 Imports

- D** LA Fitness
- E** Ralph's, RiteAid
- F** Southwestern College
- G** Walmart, Home Depot, Walgreens

- H** AMC Theatres, Best Buy, Macy's
- I** Millenia (Proposed)
- J** Von's
- K** Chula Vista Elite Athlete Training Center

FOR MORE
INFORMATION

STEWART KEITH

858.875.4669

skeith@flockeavoyer.com

License ID: 01106365



Commercial Real Estate

6165 Greenwich Drive, Suite 110

San Diego CA, 92122

619.280.2600

flockeavoyer.com



All information regarding this property is deemed to be reliable, however, no representation, guarantee or warranty is made to the accuracy thereof and is submitted subject to errors, omissions, change of price rental, or withdrawal without notice.